

## DIRECTIONS

Scott Blvd. to Georgetown to Left on Pickford



THIS PROPERTY IS CURRENTLY AVAILABLE AND BEING SHOWN BY A NAME YOU CAN TRUST:

**SUSAN HORAK** AND A COMPANY YOU'VE HEARD OF BEFORE: **RE/MAX BOONE REALTY.**

CALL TODAY FOR YOUR OWN PRIVATE SHOWING

7/9/04



The **SUSAN HORAK** Group

The #1 Listing & Selling Agent at  
The #1 Company in Columbia!

Susan doesn't just List houses, she gets them SOLD!  
That's why She's "The Leading Lady!"



**RE/MAX**  
Boone Realty

Susan Horak

Platinum Club, GRI, CRS,  
Multi Million Dollar Producer

RE/MAX Ace Award Winner 1999, 2001, 2002, 2003

33 E. Broadway • Columbia, Missouri 65203

Office: (573)876-2849 • (573)447-2146

Fax: (573)447-0155 • Residence: 874-2249

Car: (573)864-0160

email: susan@susanhorak.com

WWW.SUSANHORAK.COM

4 BEDROOMS 2 BATH 1 CAR GARAGE

\$950 month



1408  
*Pickford*  
Spacious Rental in the Georgetown Neighborhood

ANOTHER EXCELLENT PROPERTY OFFERED BY SUSAN HORAK

**The Fine Print:** All measurements contained in this flyer are estimates. The information contained herein is furnished by the owner to the best of her or his knowledge, but is subject to verification by the purchaser, and agent assumes no responsibility for correctness thereof. The sale offering is made subject to errors, omissions, change of price, prior sale, or withdrawn without notice. In accordance with the law, this property is offered without respect to race, color, creed, religion, sex, familial status, disability, ancestry and sexual orientation.



• **4 Bedrooms** • **2 Baths** • **1 Car Garage**

This ranch rental in the Georgetown neighborhood offers a large Living Room and Kitchen with Breakfast area, Full Basement with large Family Room. Master Bedroom Suite and a fenced yard with mature landscaping.



**ROOM MEASUREMENTS**

Main Level Sq. Ft. **1253**

Living Room:  
17'7 x 11'5

Dining Room:  
17'7 x 9'11

Master Bedroom:  
11'11 x 13'6

Kitchen:  
12'6 x 8'7

Bedroom:  
11'11 x 11'6

Bedroom:  
9'7 x 11'6

Lower Level Sq. Ft. **806**

Bedroom:  
15'2 x 10'9

Total Sq. Ft. **2059 (m/l)**

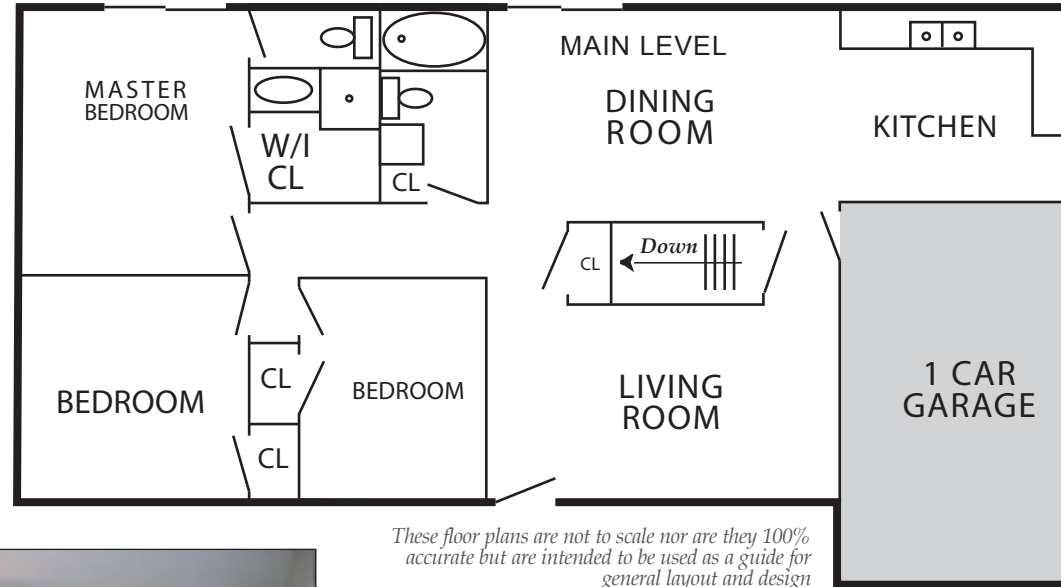

These floor plans are not to scale nor are they 100% accurate but are intended to be used as a guide for general layout and design

Address: 1408 Pickford Place

Legal Description: Lot 25 Georgetown Plat 1

Lot Size: 112.6 x 145.64 (m/l)

Schools: New Haven / Gentry/Jefferson / Rockbridge

